

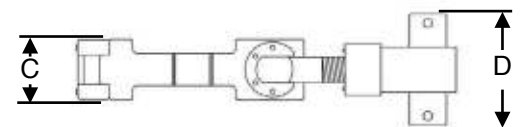

Bio-Ease HD Tubing Clamp
Specification Sheet | 035

[Click Here for Brochure](#)

The Bio-Ease™ HD Clamp has been designed for critical fluid applications within the Biotechnology and Pharmaceutical industries. With the quick swing-away lock nut, it provides for user-friendly operation. It may be installed on existing tube assemblies without disrupting the process fluid path.

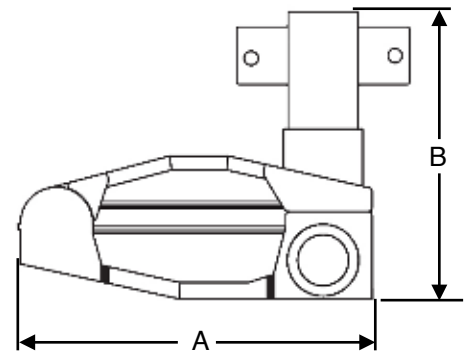
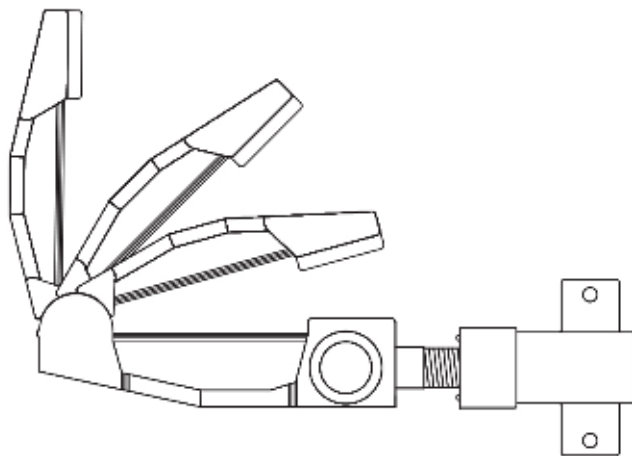

Bio-Ease HD Tubing Clamp Dimensions

Part Number	A	B	C	D
PTL-BFC-101	3.03"	2.45"	0.79"	1.48"

Bio-Ease HD Tubing Clamp

Size Range	0.187" ID to 0.5" ID
Material	Zytel® Nylon 66 with 33% Glass Fill
Applications	Clamp silicone, TPE, TPV, PVC and Rubber tubes
Pack Size	Individual or Multiples
Options	Laser Engraving



Products Meet

